

precast concrete steps

operable vent provides fresh air and temperature control

concrete cold room ceiling

soil level

**BLAST GATE DETAILS**

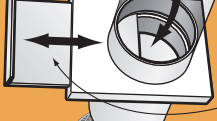

2" (50mm) extruded polystyrene foam extends 12" (300mm) below level of frost penetration.

wood strips fit into these slots and provide anchor surface for wall covering

1x4 (100x25mm)

2x4 (100x50mm)

valve plate slides to open and close blast gate

site-built, T-shaped wooden prop holds foam up during installation

waterproof coating applied to interior foundation wall surfaces

flexible plastic drainage tile around perimeter of foundation

masonry foundation walls

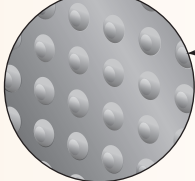

dimpled drainage membrane

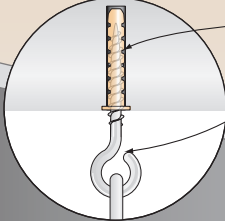

metal anchor insert in predrilled hole in concrete ceiling

eyebolt with 3/8" (9.5 mm) shank diameter

**ANCHOR EYEBOLT FOR HANGING SHELF**

cold rooms sometimes have corrugated steel ceilings like this

pull blind down to keep cold room dark, raise to let in light while working inside

edges sealed with expanding polyurethane foam

hanging shelf system

light switch with illuminated ON indicator

exterior-grade, insulated door

basement floor

**COLD ROOM DETAILS**